

ROSEVILLE
REQUEST FOR COUNCIL ACTION

Date: 6/23/14
Item No.: 7.f

Department Approval



City Manager Approval



Item Description: Consider Resolution Requesting Jurisdictional Transfer of County Road B from its Western Terminus to Cleveland Avenue

BACKGROUND

County Road B west of Cleveland Avenue is currently a Ramsey County facility and is designated as a County State Aid Highway.

In 2007, with the collapse of the I-35W Bridge over the Mississippi River and the subsequent modifications to Trunk Highway 280 that resulted from this event in order to accommodate diverted traffic, County Road B's connection to Trunk Highway 280 was closed. When this occurred, this segment of roadway no longer met the requirements of a County State Aid Highway (CSAH) as it no longer connected to another CSAH or Trunk Highway.

Since that time, the City and the County have had numerous discussions regarding a jurisdictional transfer. With the desire to physically modify portions of the roadway to better serve as a local road, including adding a pedestrian pathway on the south side, reducing the speed limit to 30 miles per hour, and possibly reducing the striped width of the travel lanes, the need to complete the jurisdictional transfer is more pressing.

As a condition of the jurisdictional transfer, recognizing the additional maintenance costs to the City for this section of roadway and taking into account the remaining life of the 2006 pavement overlay the County performed on this section of roadway, City staff and Ramsey County have negotiated a onetime payment to the City in the amount of \$93,500. This amount will be used towards future roadway reconstruction which staff expects to be necessary in about 8-10 years.

The County is in support of the proposed jurisdictional transfer and will take action on this issue at a July County Board meeting. By revoking the CSAH status from this section of roadway, the County frees up 0.84 miles that can now be used with additional banked mileage the County has available to designate the portion of County Road B2 from Dale Street to Rice Street that is not currently designated as a State Aid Highway. This allows the County to use State Aid funding for projects in the future on this roadway.

An immediate additional benefit of this reallocation of mileage is the ability to receive funding from Ramsey County for the County Road B2 Sidewalk project. Ramsey County Cost Participation Policy provides County funding on 50% of the hard costs of a sidewalk or trail, but only along county roads that are designated as County State Aid Highways. The Cooperative Agreement for this project, which includes the cost participation for the County on the project, is also being presented to Council at this evening's Council Meeting. Please refer to that Request for Council Action for more details on that participation.

33 **FINANCIAL IMPACTS**

34 The onetime payment of \$93,500 will be deposited in the City's Infrastructure fund and used
35 towards the future reconstruction of the roadway. There will be additional maintenance activities on
36 this roadway including plowing, patching, etc. that will be an impact to the Public Works annual
37 operating budgets.

38 **STAFF RECOMMENDATION**

39 Staff recommends the Council approve the resolution concurring with Ramsey County revocation of
40 County State Aid Highway Status for County Road B, CSAH 25, from its west terminus to
41 Cleveland Avenue and requesting the jurisdictional transfer of the roadway segment to the City of
42 Roseville.

43 **REQUESTED COUNCIL ACTION**

44 Motion to approve the resolution concurring with Ramsey County revocation of County State Aid
45 Highway Status for County Road B, CSAH 25, from its west terminus to Cleveland Avenue and
46 requesting the jurisdictional transfer of the roadway segment to the City of Roseville.

47

Prepared by: Marc Culver, City Engineer
Attachments: A: Resolution
B: Map showing proposed Jurisdictional Transfer

**EXTRACT OF MINUTES OF MEETING
OF THE
CITY COUNCIL OF THE CITY OF ROSEVILLE**

* * * * *

1 Pursuant to due call and notice thereof, a regular meeting of the City Council of the City
2 of Roseville, County of Ramsey, Minnesota was duly held on the 23rd day of June, 2014,
3 at 6:00 p.m.

4
5 The following members were present: ; and the following were absent: .

6
7 Councilmember introduced the following resolution and moved its adoption:

RESOLUTION No.

**RESOLUTION CONCURRING WITH RAMSEY COUNTY REVOCATION
OF COUNTY STATE AID HIGHWAY STATUS
FOR COUNTY ROAD B, CSAH 25, FROM
IT'S WEST TERMINUS TO CLEVELAND AVENUE AND REQUESTING THE
JURISDICTIONAL TRANSFER OF THE ROADWAY SEGMENT TO THE
CITY OF ROSEVILLE**

8
9
10
11
12
13
14
15
16
17
18 WHEREAS, the standards for County State Aid Highways require them to connect with
19 another County State Aid Highway or State Trunk Highway, or to a regional trade center;
20 and,

21
22 WHEREAS, the collapse of the I-35W bridge over the Mississippi River prompted the
23 Minnesota Department of Transportation to remove the access of County Road B to
24 Minnesota Trunk Highway 280, thereby creating a dead-end street; and,

25
26 WHEREAS, the removal of access to TH 280 made County Road B, west of Cleveland
27 Avenue a non-conforming County State Aid Highway; and,

28
29 WHEREAS, as a non-conforming County State Aid Highway, Ramsey County is
30 compelled to remove it from its County State Aid Highway system.

31
32 WHEREAS, County Road B (County State Aid Highway 25) from its western terminus
33 to Cleveland Avenue, a total of 0.84 miles in length, located in the City of Roseville, is
34 presently under the jurisdiction of Ramsey County as a County State Aid Highway; and,

35
36 WHEREAS, this roadway has been determined to serve a local function only; and,
37

38 WHEREAS, Revocation of “County State Aid Highway” status may be accomplished by
39 resolution of the Ramsey County Board of Commissioners pursuant to Minnesota
40 Statutes 162.02; and,

41
42 WHEREAS, City and County staff have agreed that fair compensation to the City for
43 future liabilities associated with the jurisdictional transfer of County Road B would be a
44 onetime, lump-sum payment of \$93,500.00 from the County to the City; and,

45
46 NOW, THEREFORE, BE IT RESOLVED, that the City Council of the City of Roseville
47 does hereby request that the Ramsey County Board of Commissioners revoke the
48 “County State Aid Highway” status of County Road B (County State Aid Highway 25)
49 from its western terminus to Cleveland Avenue and transfer jurisdiction over the roadway
50 to the City of Roseville, effective after the County, in receipt of an adopted resolution
51 from Roseville requesting the County revoking the “County State Aid Highway” status of
52 County Road B (County State Aid Highway 25) from its western terminus to Cleveland
53 Avenue, adopts a County Board Resolution transferring said jurisdiction; and

54
55 FURTHER, The Roseville City Engineer is authorized within the limits of this resolution
56 to take actions necessary to have the identified jurisdiction changes executed.

57
58 The motion for the adoption of the foregoing resolution was duly seconded by
59 Councilmember and upon vote being taken thereon, the following voted in favor
60 thereof: ; and the following voted against the same: .

61
62 WHEREUPON said resolution was declared duly passed and adopted.

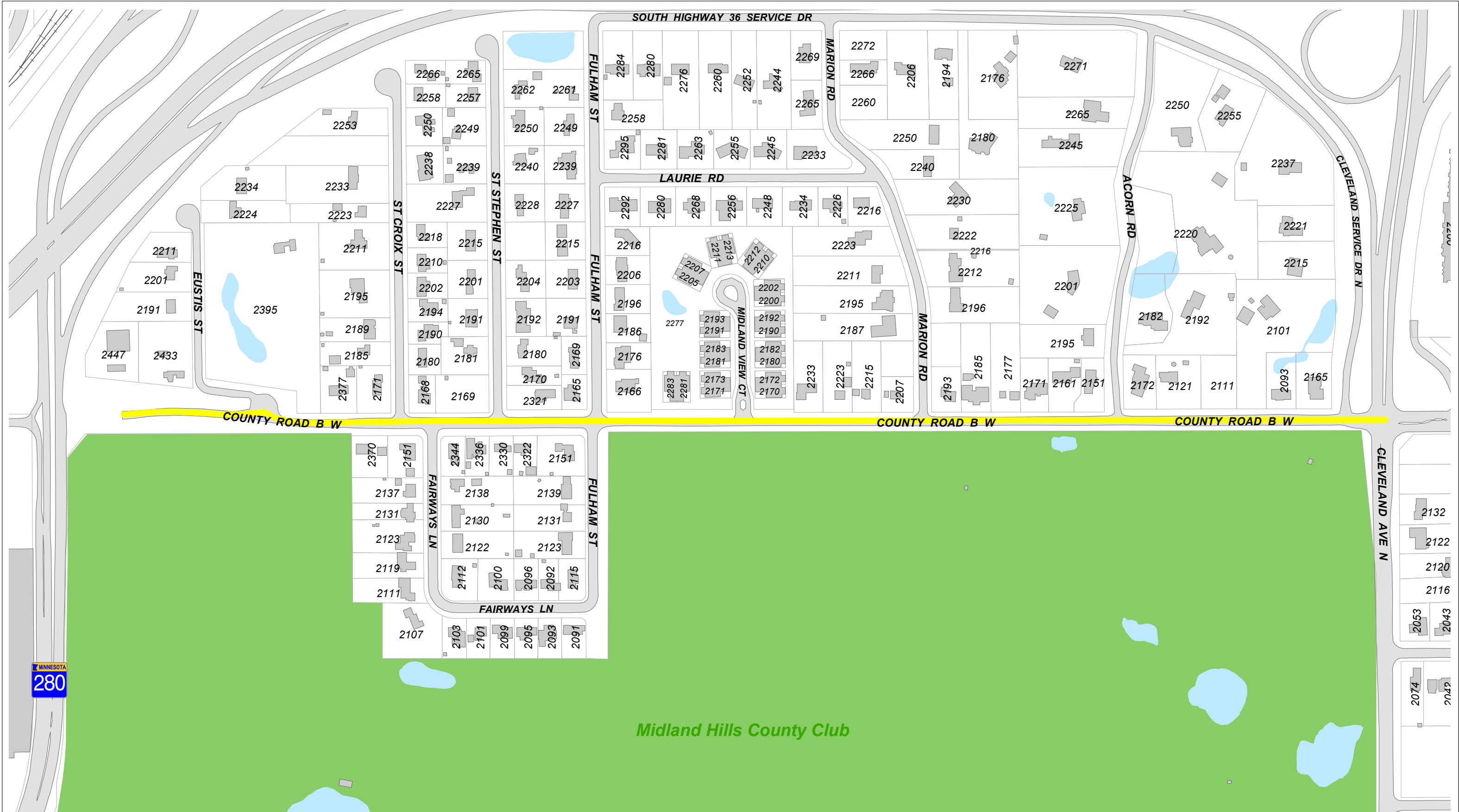

County Road B Jurisdiction Transfer



Prepared by:
Engineering Department
June 13, 2014

 County Road B Transfer Segment

Data Sources and Contacts:
* Ramsey County GIS Base Map (6/2/14)
* City of Roseville Engineering Department
For further information regarding the contents of this map contact:
City of Roseville, Engineering Department,
2660 Civic Center Drive, Roseville MN

DISCLAIMER:
This map is neither a legally recorded map nor a survey and is not intended to be used as one. This map is a compilation of records, information and data located in various city, county, state and federal offices and other sources regarding the area shown, and is to be used for reference purposes only. The City does not warrant that the Geographic Information System (GIS) Data used to prepare this map are error free, and the City does not represent that the GIS Data can be used for navigational, tracking or any other purpose requiring exacting measurement of distance or direction or precision in the depiction of geographic features. If errors or discrepancies are found please contact 651-792-7075. The preceding disclaimer is provided pursuant to Minnesota Statutes §466.03, Subd. 21 (2000), and the user of this map acknowledges that the City shall not be liable for any damages, and expressly waives all claims, and agrees to defend, indemnify, and hold harmless the City from any and all claims brought by User, its employees or agents, or third parties which arise out of the user's access or use of data provided.

0 100 200 300 400 Feet

mapdoc: CountyRoadBJurisdictionTransfer.mxd
map: CountyRoadBJurisdictionTransfer.pdf

